

Energy Sense Automations

Geyser Temperature
automation
Quick Reference Guide

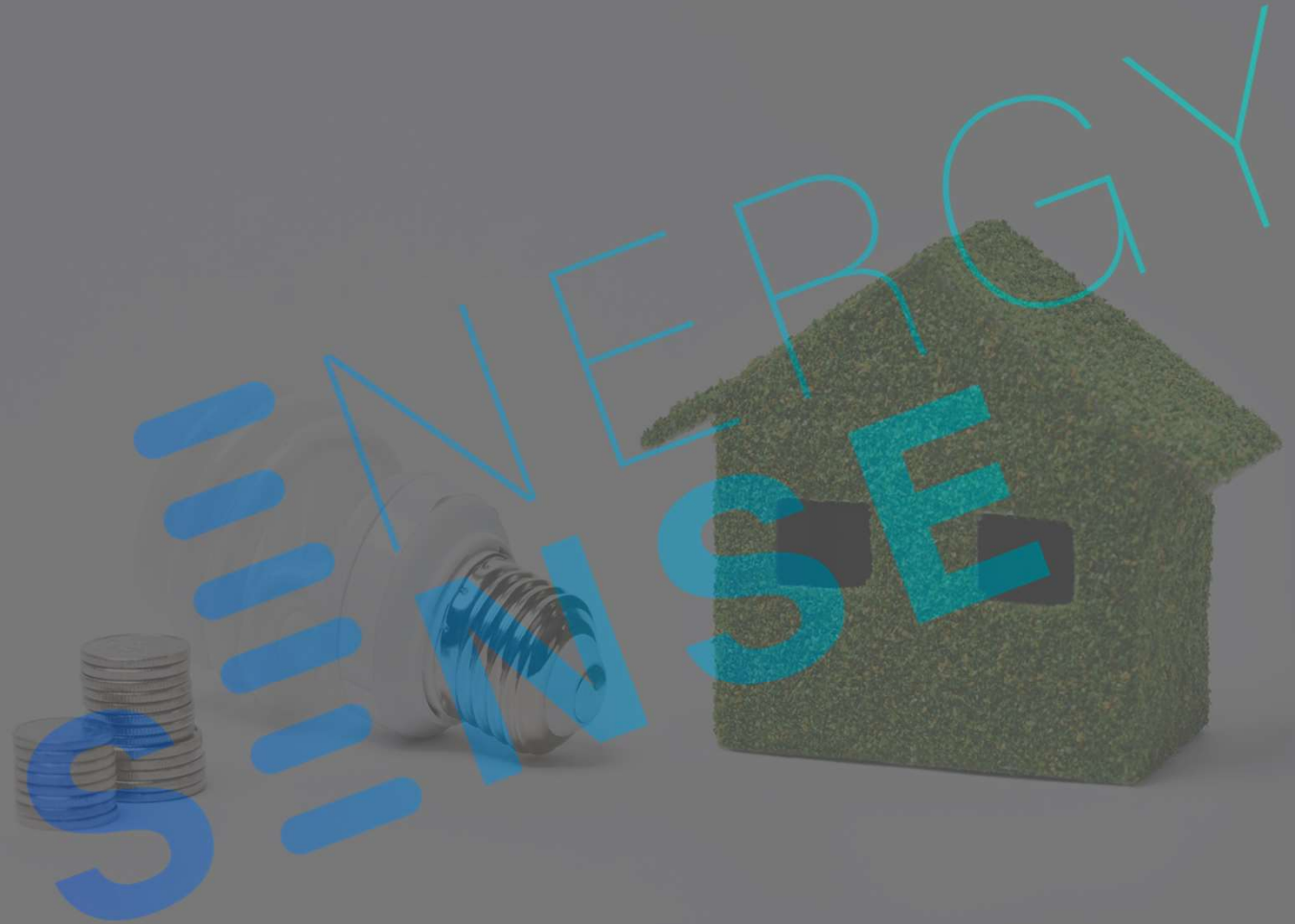

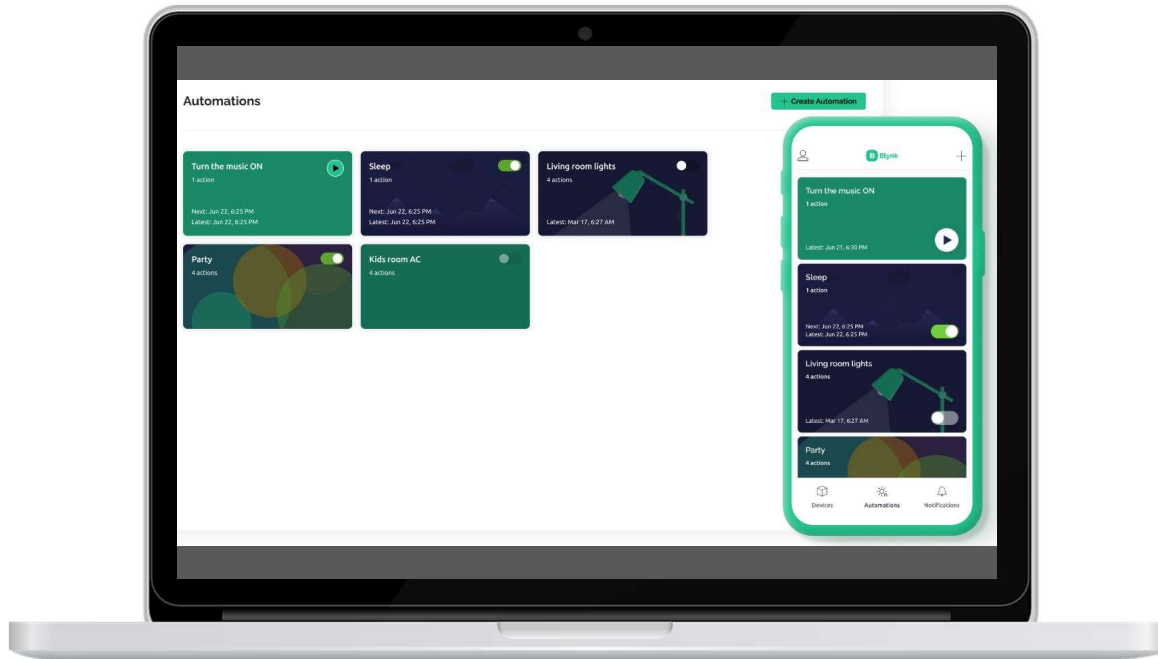

Automations

Automations allow the end-user of the Energy Sense app to create scenarios where the device automatically performs one or more **actions** based on a **condition**.

We carefully defined which parameters of the device can be automated by end customers to provide the optimal solution

Automations

Conditions

- **Schedule:** triggers an event based on the current date/time reaching a particular set of date/time values (all relative to a specified time zone)
- **Sunrise/Sunset:** triggers an event when the time before/after sunrise/sunset occurs relative to a set of defined weekdays, at a specific geographic location.
- **Device State:** triggers an action based on the value of a Datastream (device Sensor or data point).
- **Scene:** manually triggers an automation scenario from the mobile App.

Actions

- **Notification:** sending a mobile app notification
- **Device data:** forwarding device data to some other device datastream
- **Email:** sending an email
- **Delay:** setting a delay
- **Datastream** Setting a datastream value (change in value).

Geyser Temperature Automation

From the Mobile App click on the 'Automations' icon at the top of the home screen.

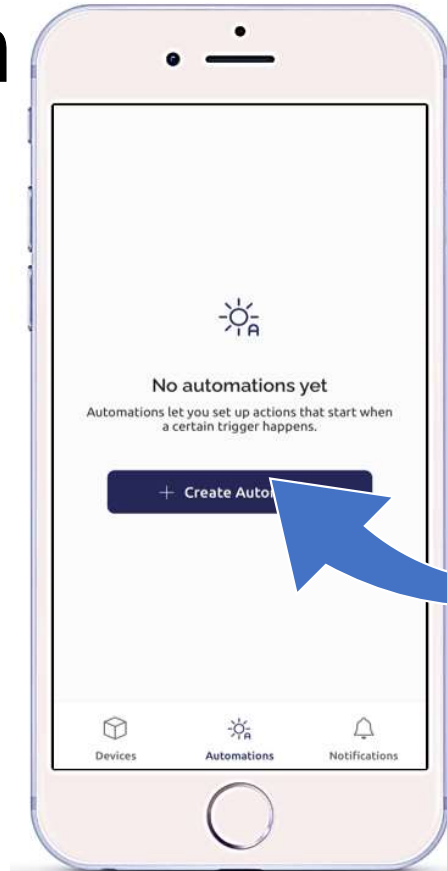
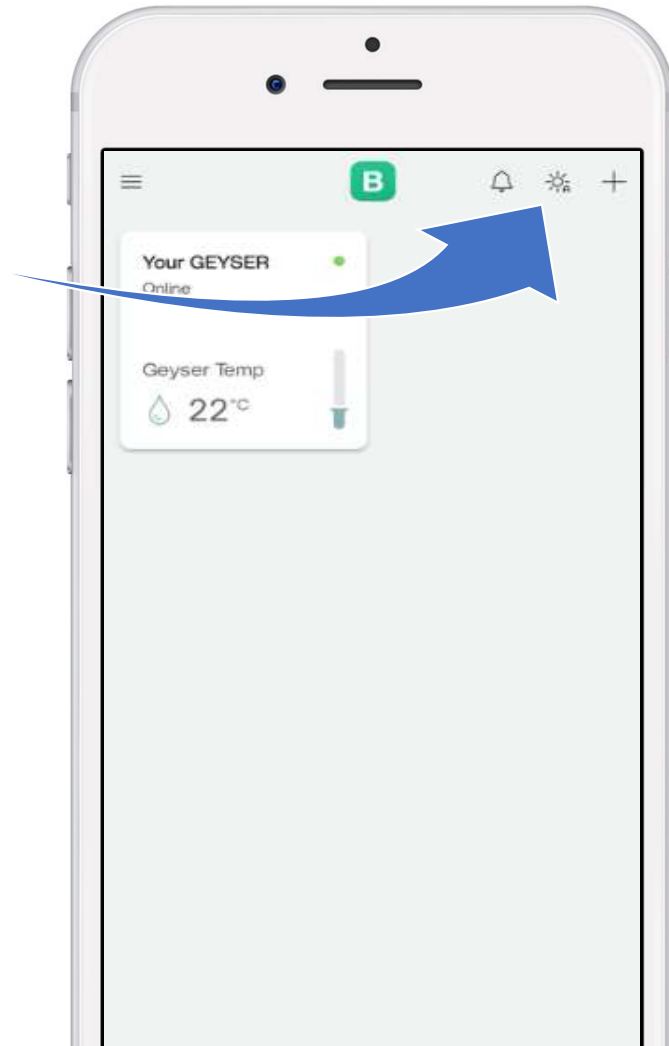

Click on New Automation

Click on Automations

This example's automation will display a message on your mobile device when the Geyser Temperature goes below 30°C.

Create Automation (Geyser Temp)

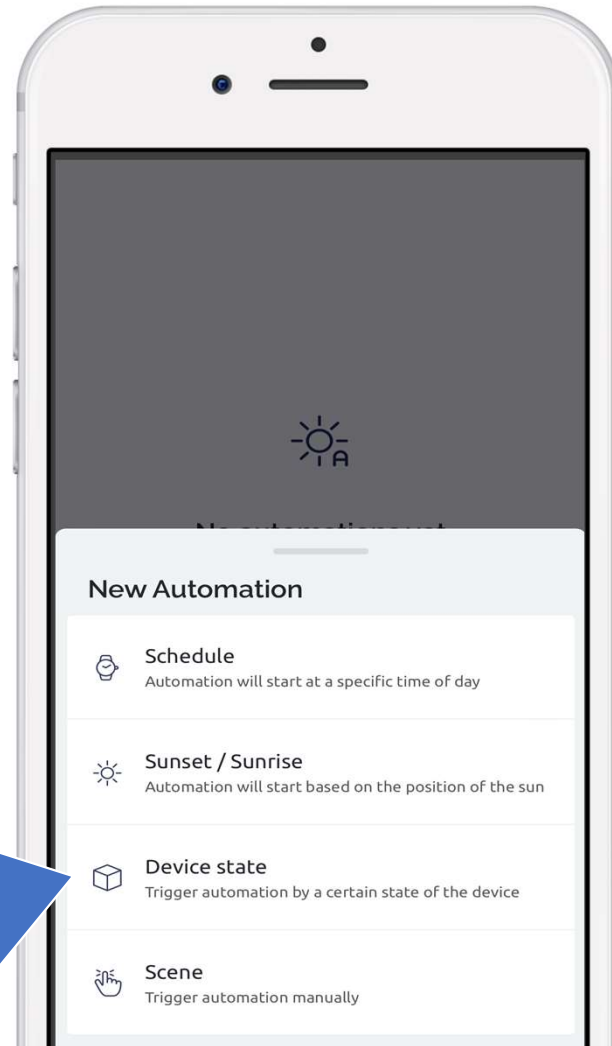

Triggers an action based
on the value of a
Datastream (sensor value)

Automation - Select Device

Select GCU (Geyser
Control Unit)

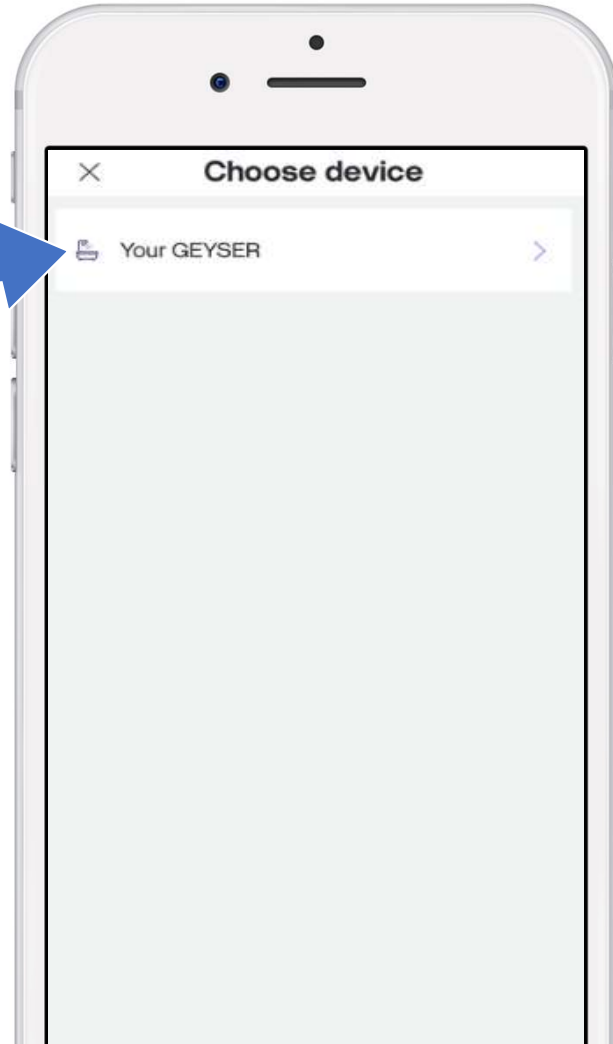

Automation – Device property

Select ntc1 Temp (Geyser
Thermostat Temperature)

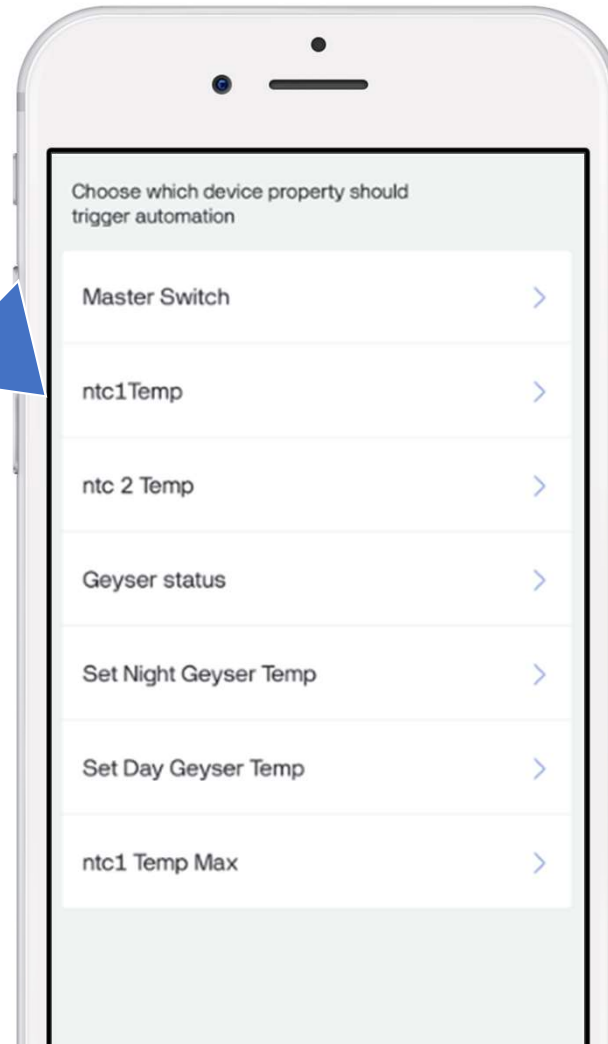

Automation – Condition

Select ntc1 Temp (Geyser
Thermostat Temp)

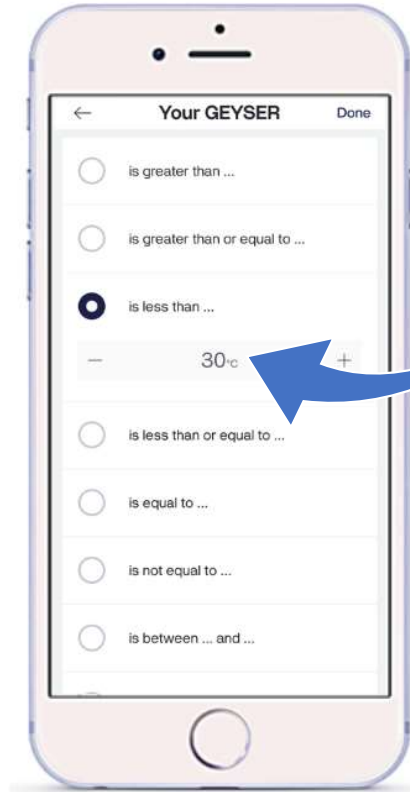
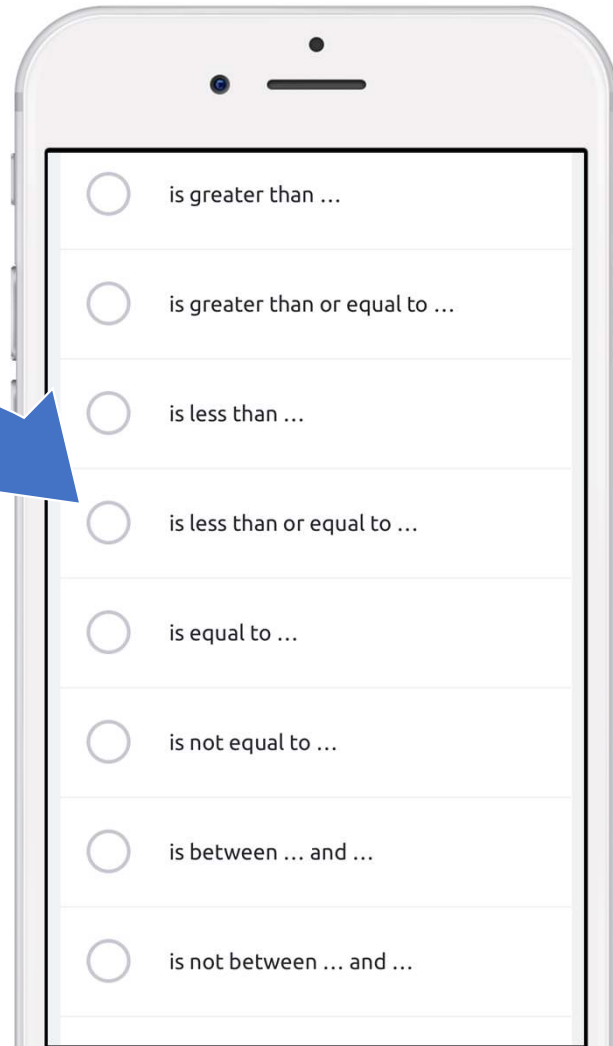

Set the Temp value for the
automation to trigger



Automation – Actions based condition

Add an action: What will happen when the Temp is below 30°C?

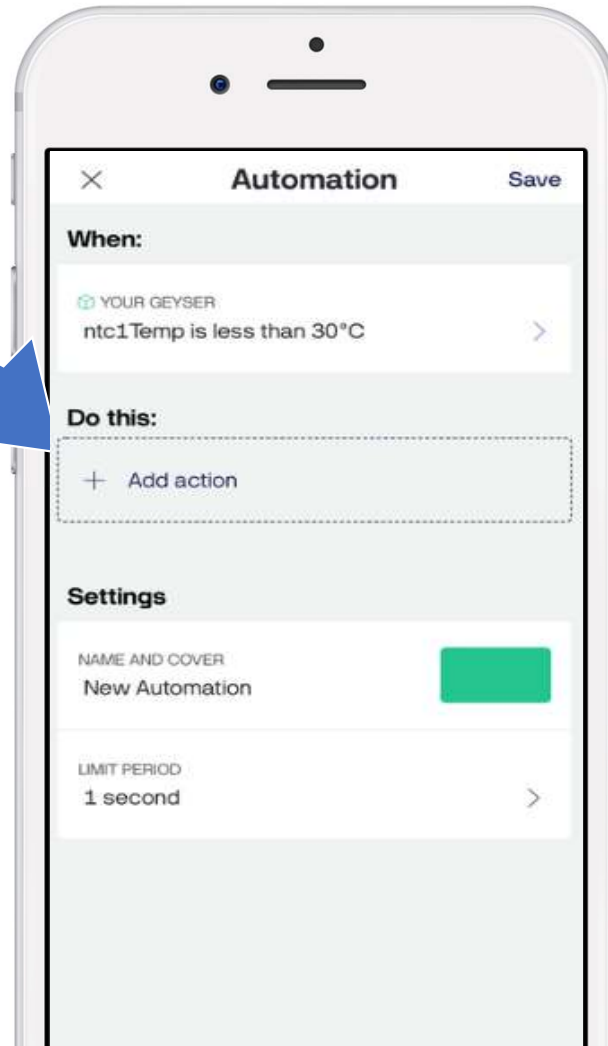

Control device
(In this case, we want to send a Message)

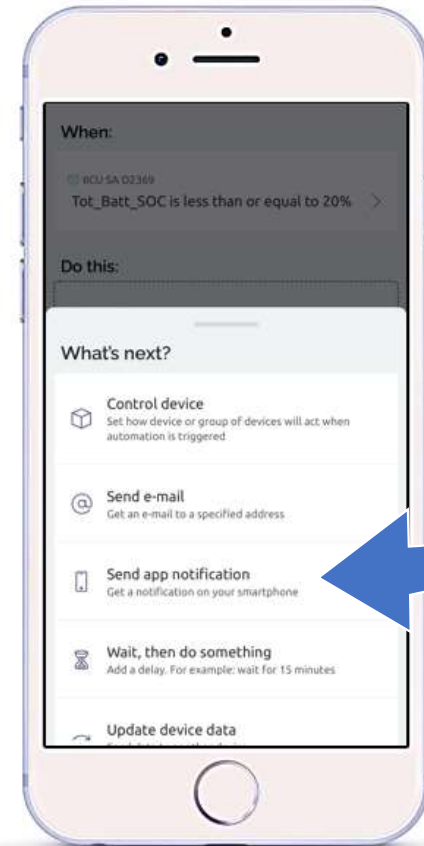
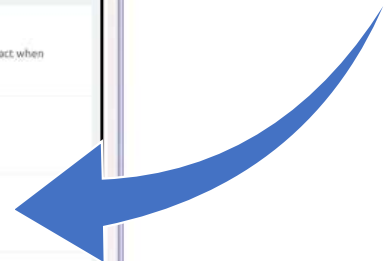

Automation – Device Message

In App Message



Automation – In-App Notification

Name the Automation

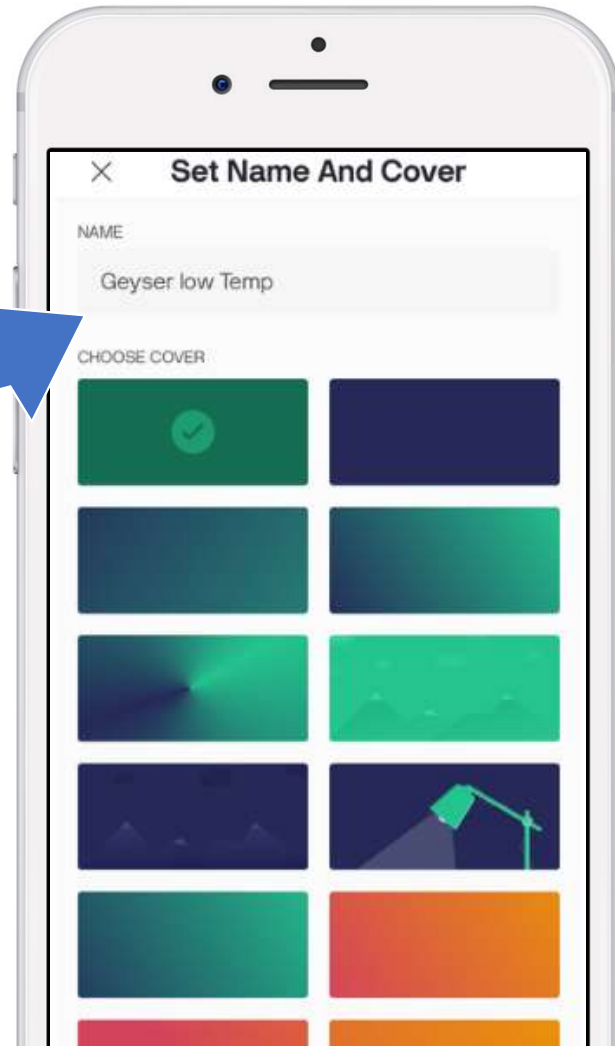

Automation – Automation Triggered

When Triggered will the
message display on your
mobile

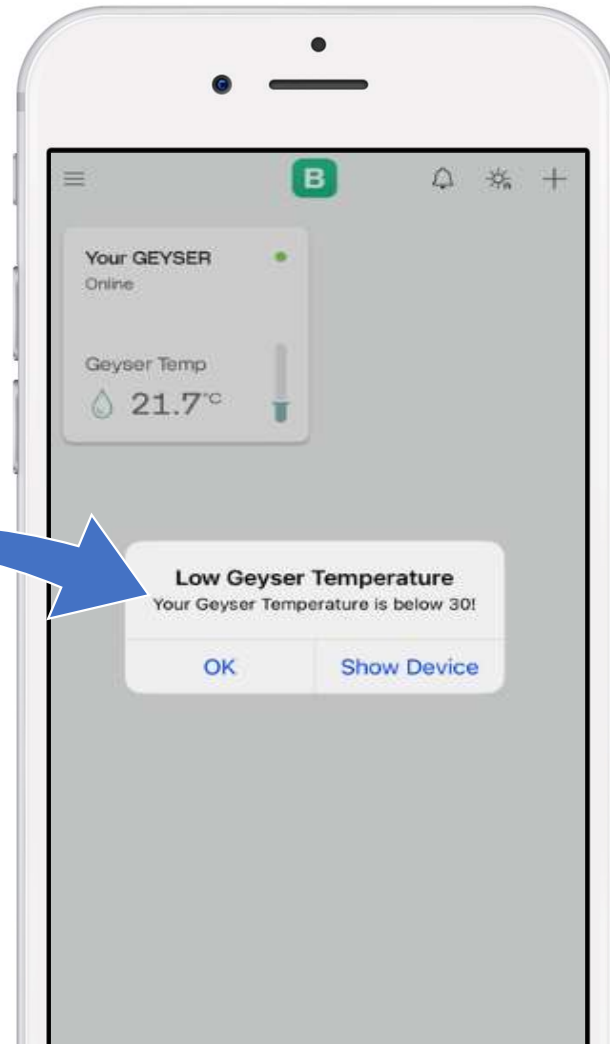

EM 2 Channel 1-4

CH2 CH3 CH4

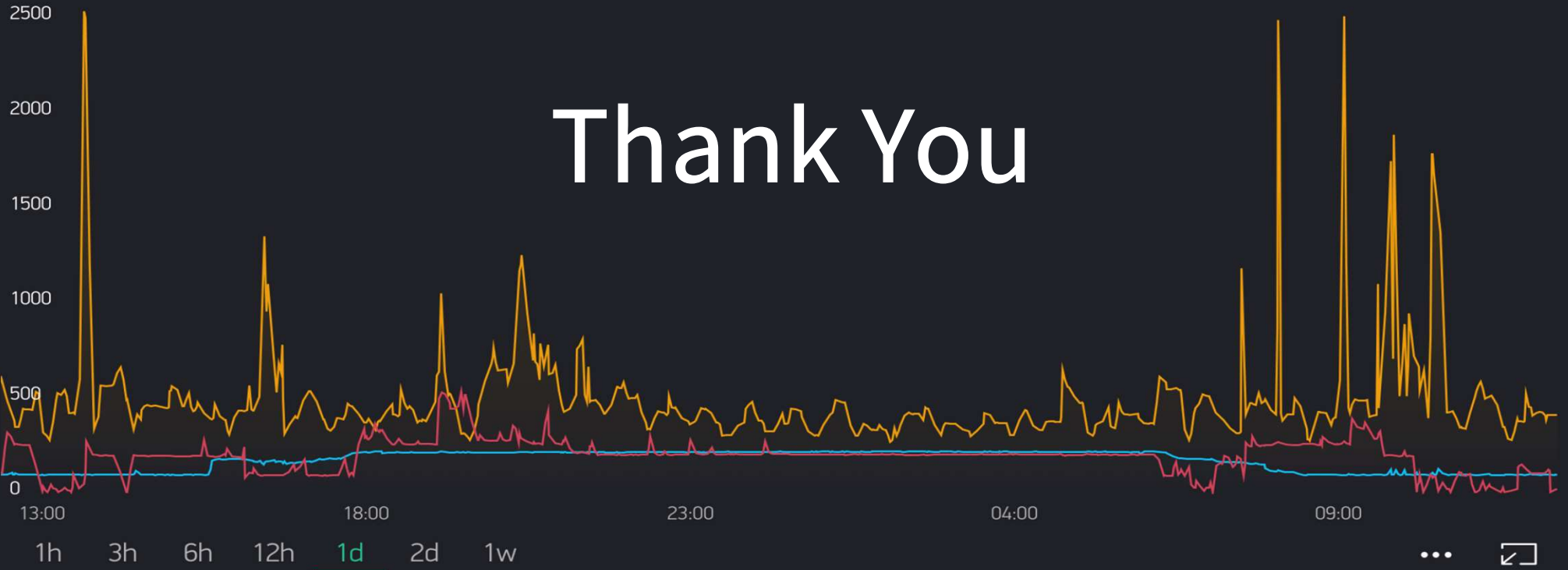

Thank You

ENERGYSENSE